

8 7 6 5 4 3 2 1

D
C
B
A

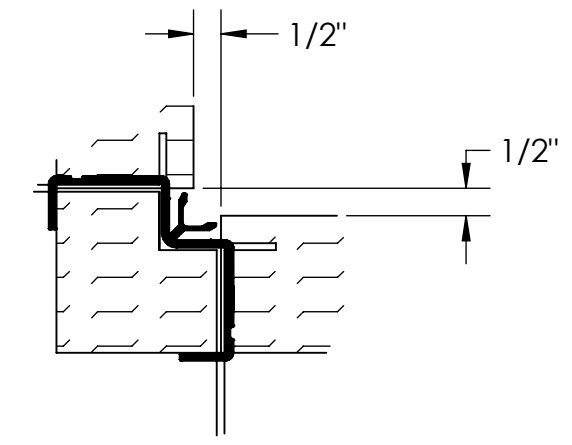
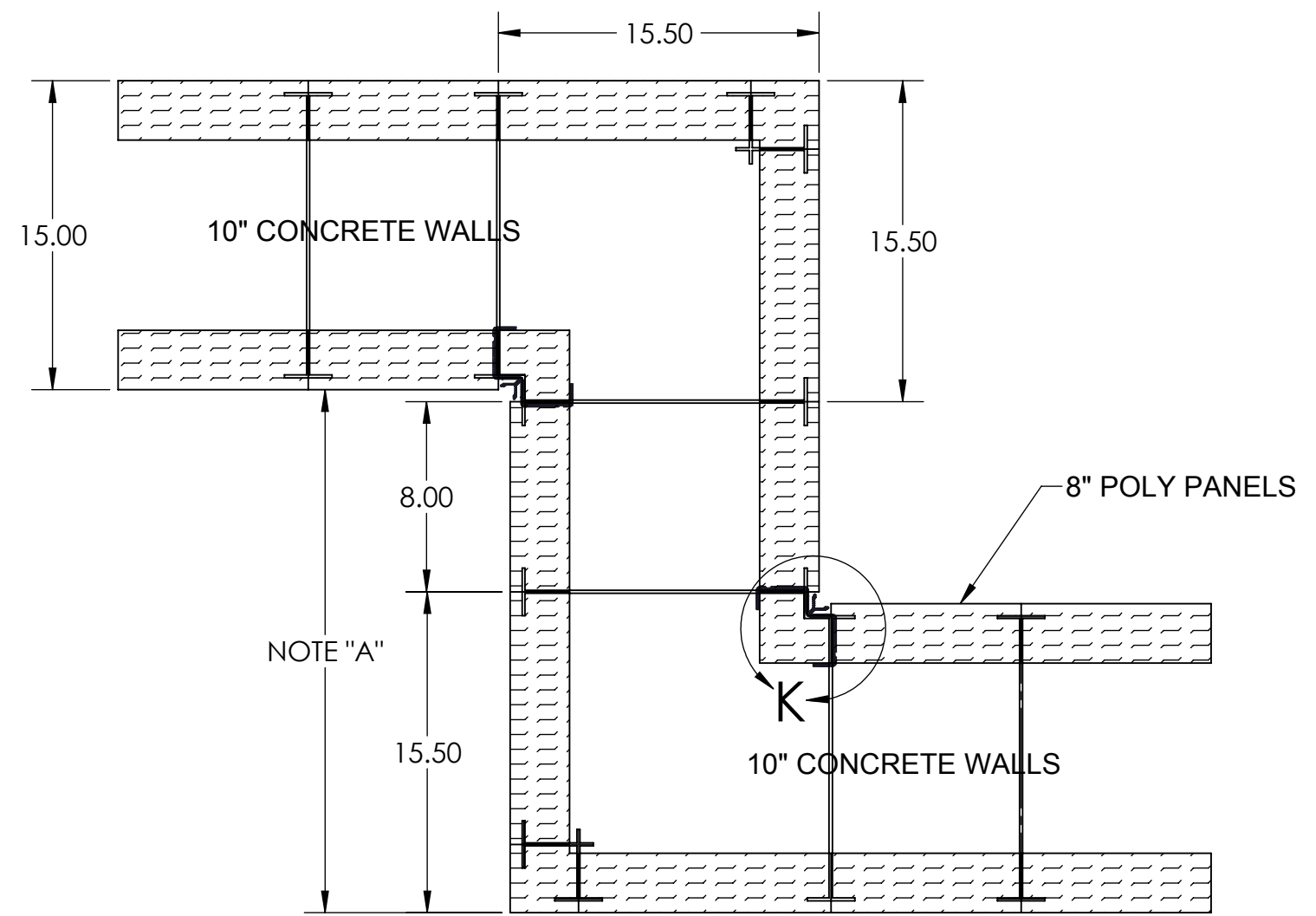

DETAIL K
SCALE 2 : 7

CONFIDENTIAL
THE INFORMATION ON THIS DRAWING IS STRICTLY CONFIDENTIAL AND IS NOT TO BE DISCLOSED, COPIED, OR DISTRIBUTED.

NOTE "A"
-OPTIMAL DIMENSIONS FOR 10" CONCRETE WALL BUMP OUT CORNER ARE: 16",24",32",40",48",56" CONTINUE EVERY 8"

	MATERIAL: EXPANDED POLYSTYRENE 1.5 LB/CUBIC FT NOMINAL		THERMOFORM SYSTEM	
	UNLESS OTHERWISE SPECIFIED:		TITLE: OPTIMAL BUILDING LAYOUT DIMENSIONS FOR 10" CONCRETE WALLS	
EPS blocks are to be stabilized at ambient temperature for a minimum of 72 hours before the cutting/fabrication process. Optional forced curing for 24 hours at 140 degrees Fahrenheit prior to the cutting/fabrication process is an acceptable alternative.	DIMENSIONS ARE IN INCHES		SIZE B	DWG. NO. N/A
	DATE: 01-09-2015		REV 1	
DRAWN BY: LME	SCALE: 1:7			SHEET 1 OF 1

8 7 6 5 4 3 2 1