

Bracing 8ft & 9ft corner assembly

Use this same method for 9ft tall walls

Put horizontal walers at third points (3ft & 6ft) on a 9ft wall

Move to 3 horizontal walers @ 1/4 points for 10ft or 12ft high walls

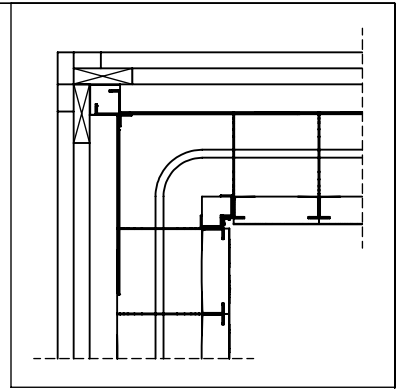

90° CORNER
TOP VIEW

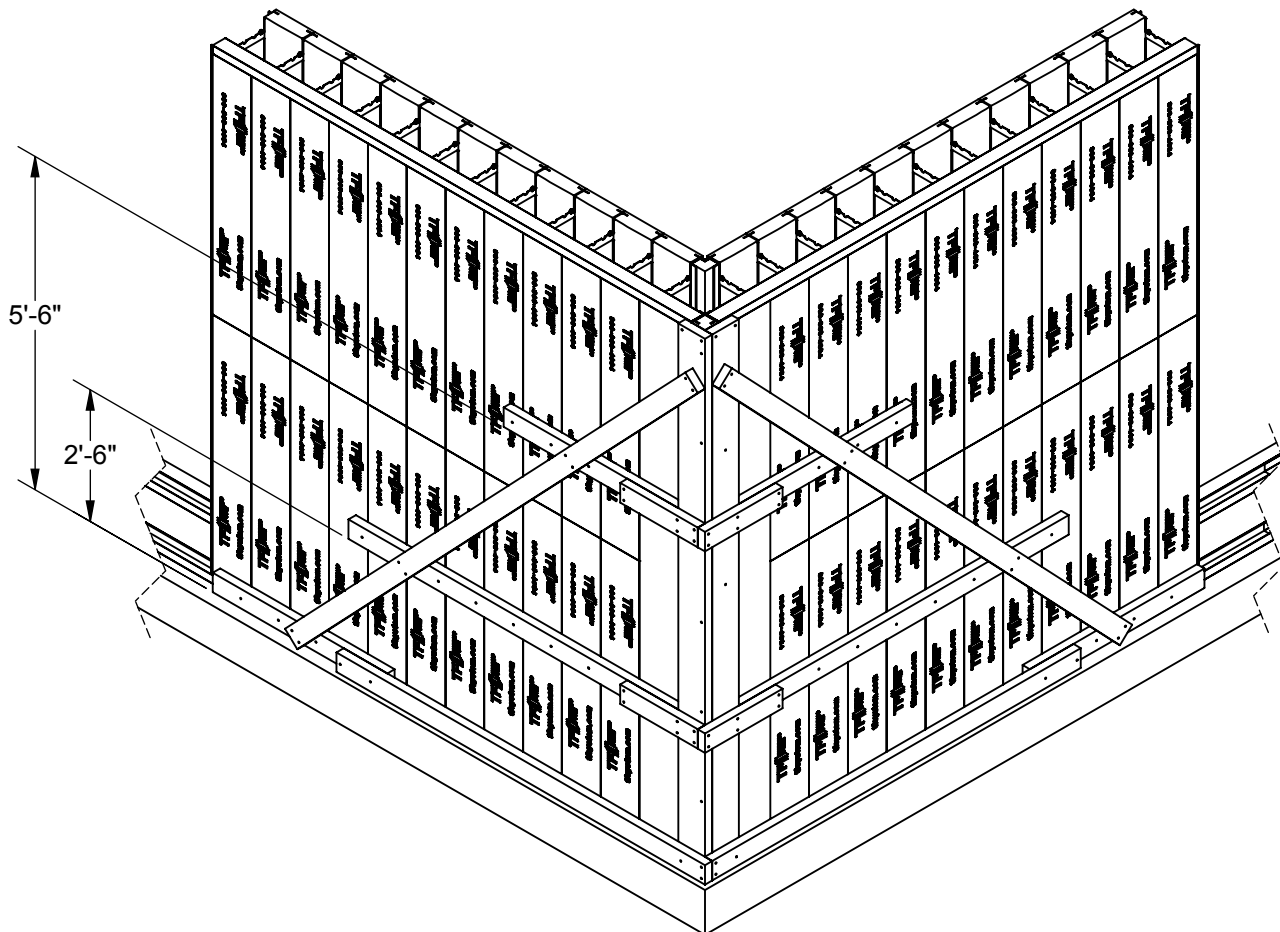

Horizontal corner brace layout

See your TF Rep.
for setting up corner
bracing on concrete
10" thick or more

NOTE:

This bracing is used to stop the corner
from twisting under concrete pressure

Contractor assumes all
responsibility for design
and implementation
of bracing



Completed Corner Bracing

ThermoForm

TF Forming Systems, Inc
800-360-4634
www.TFSystem.com

Date: 9/11/2013