

Section 5

Building Techniques

Slide rebar into position from the open end of wall

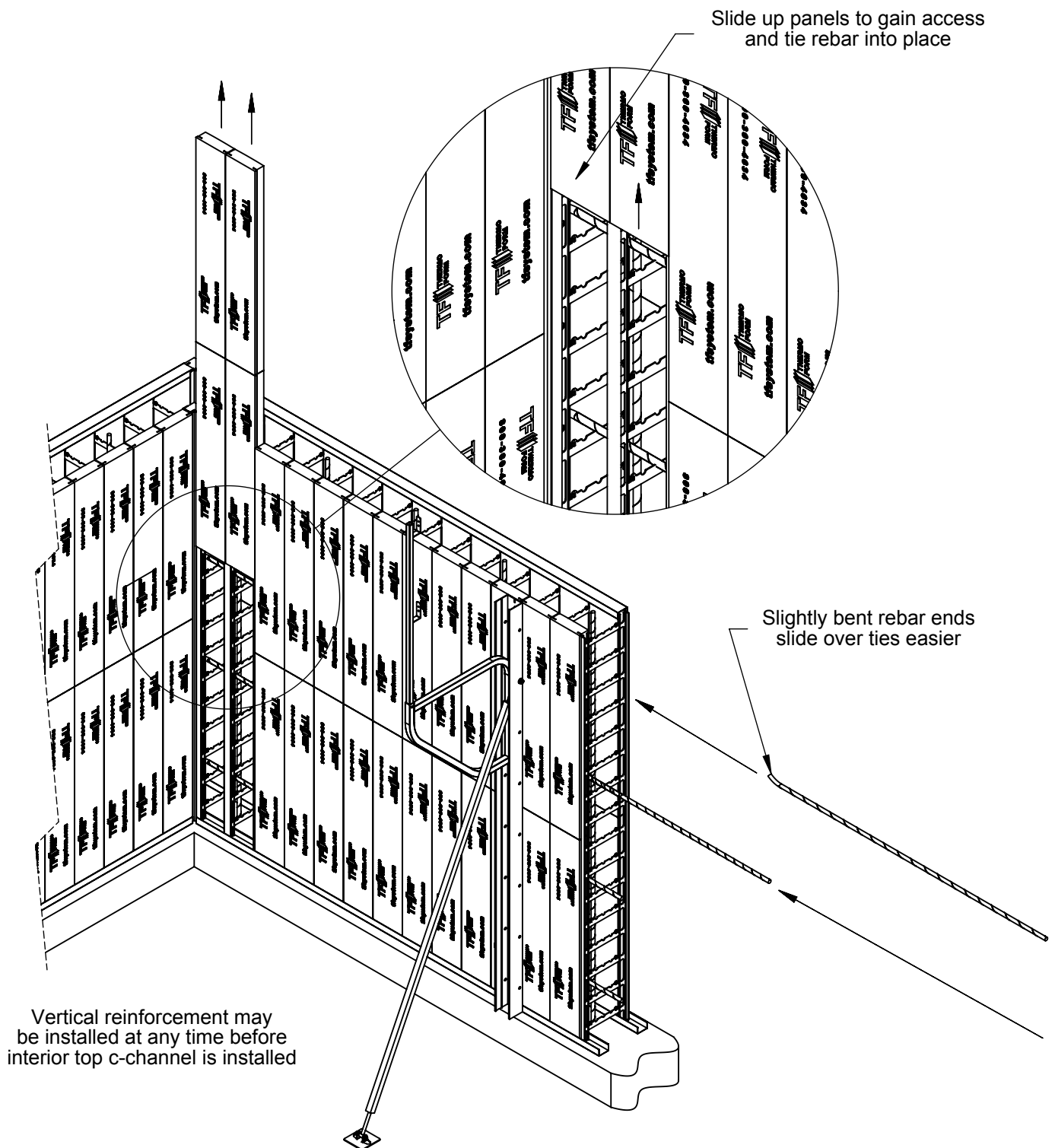

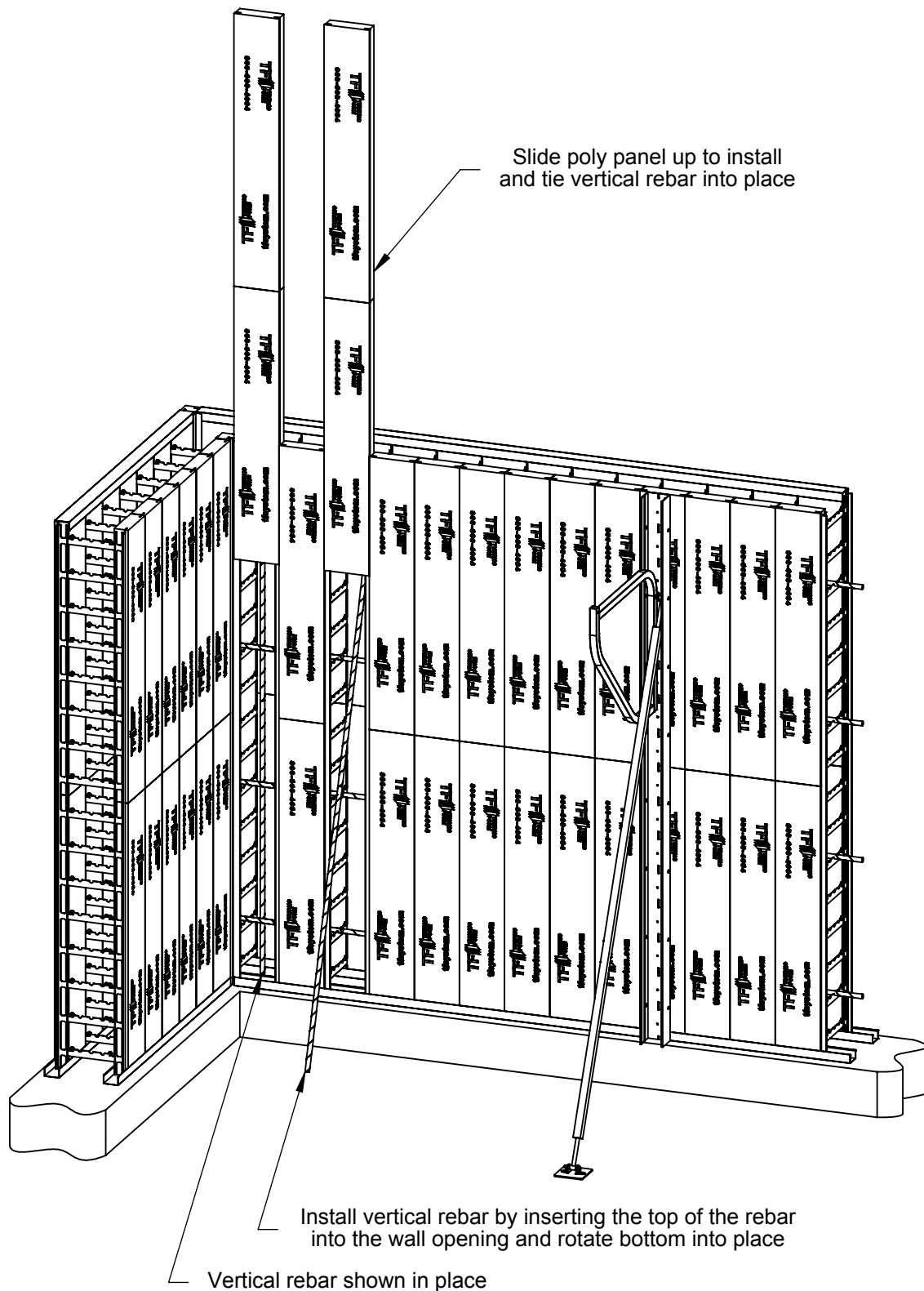

After mounting upper c-channel with proper overlap, straighten wall with string line

Once wall is straightened, screw c-channels together with steel stud screws or sheet metal screws

As you build the wall, install the upper exterior c-channel to help stiffen the wall and help hold everything together

Exterior c-channel

Interior of wall

16"
Overlap

Installing upper interior c-channel is the last step. This will allow for the panels to be slid up for access to the cavity.

After all the rebar is tied, the wall is inspected, and the bottom of the cavity is cleaned out, then the interior c-channel may be installed.

If you need a T-Intersection

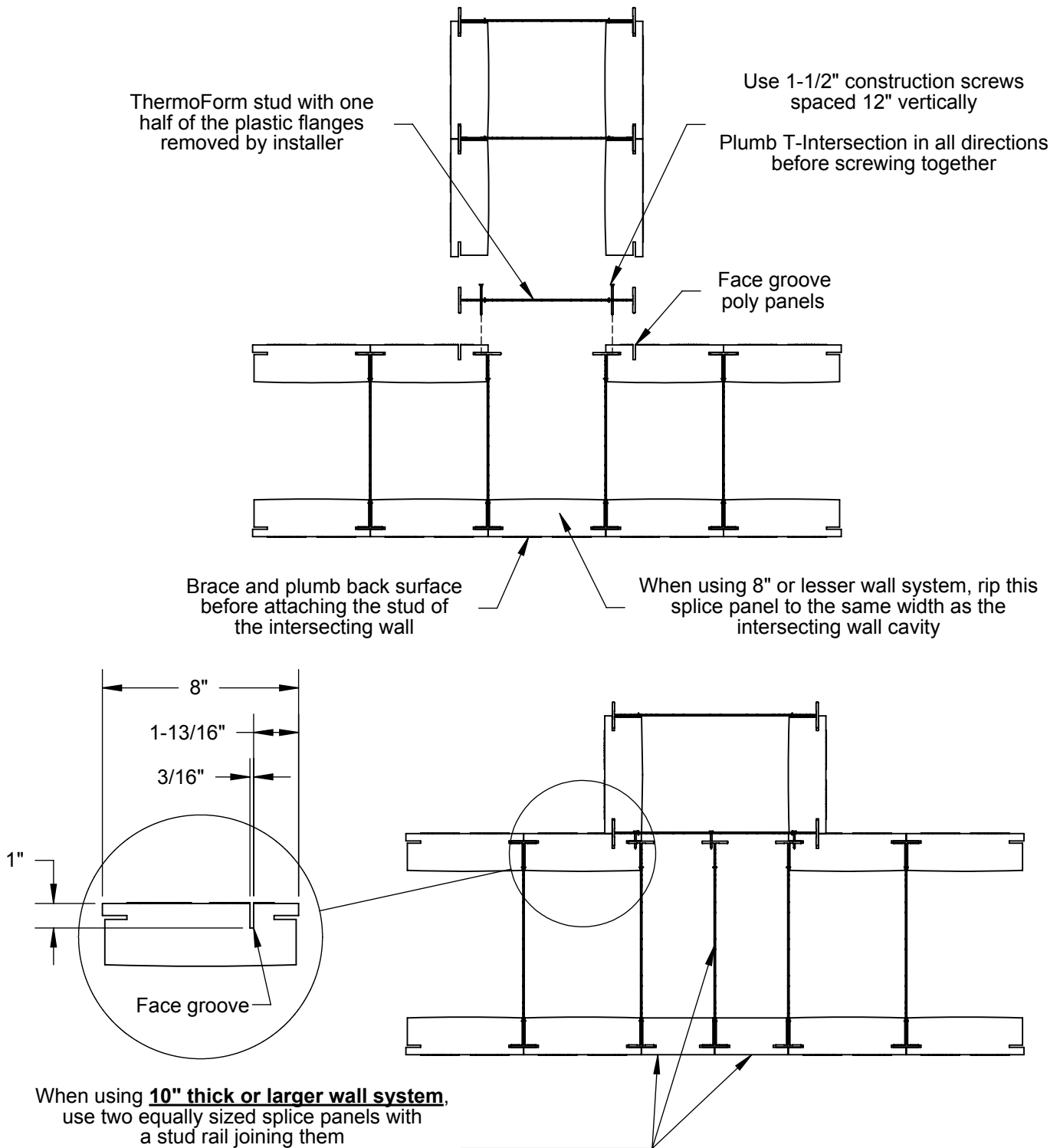

Contact a TF Forming Systems representative for additional bracing information

T - Intersection Bracing

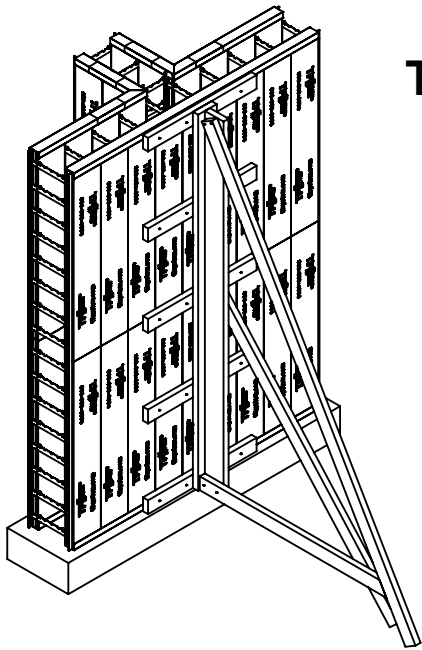

Do not flow concrete
in this direction
(if possible)



Always try to flow concrete
away from the T-Intersection

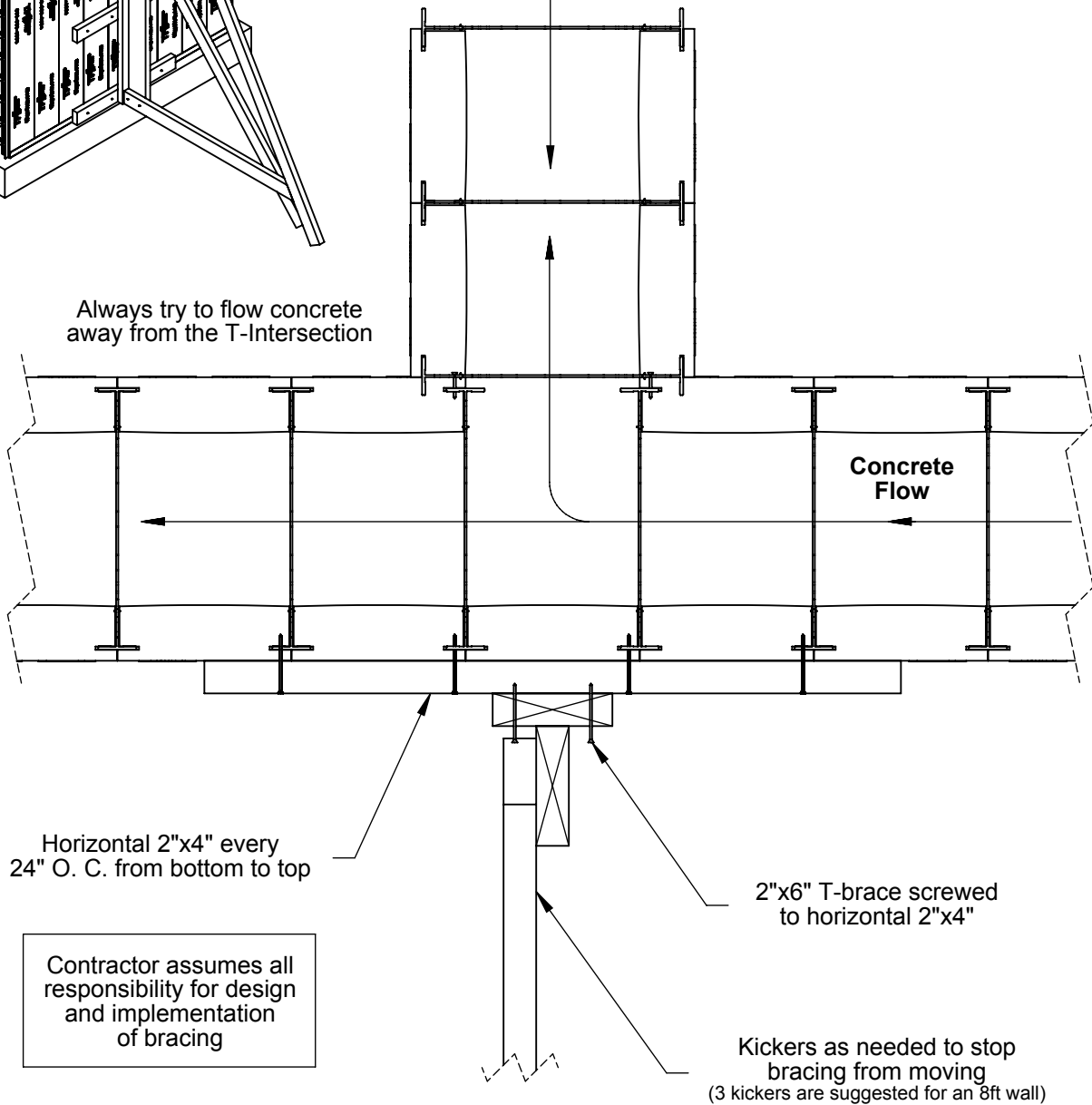

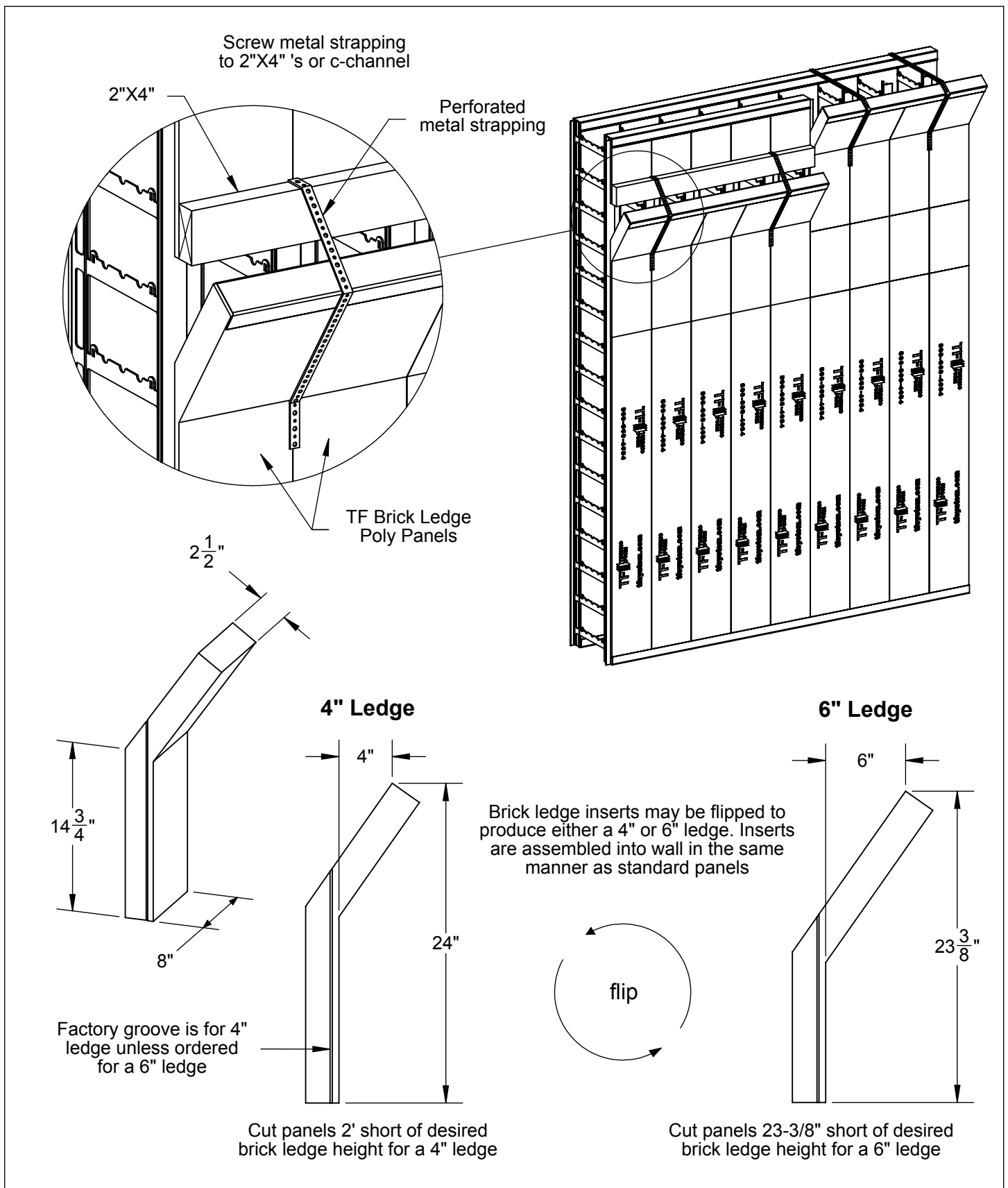

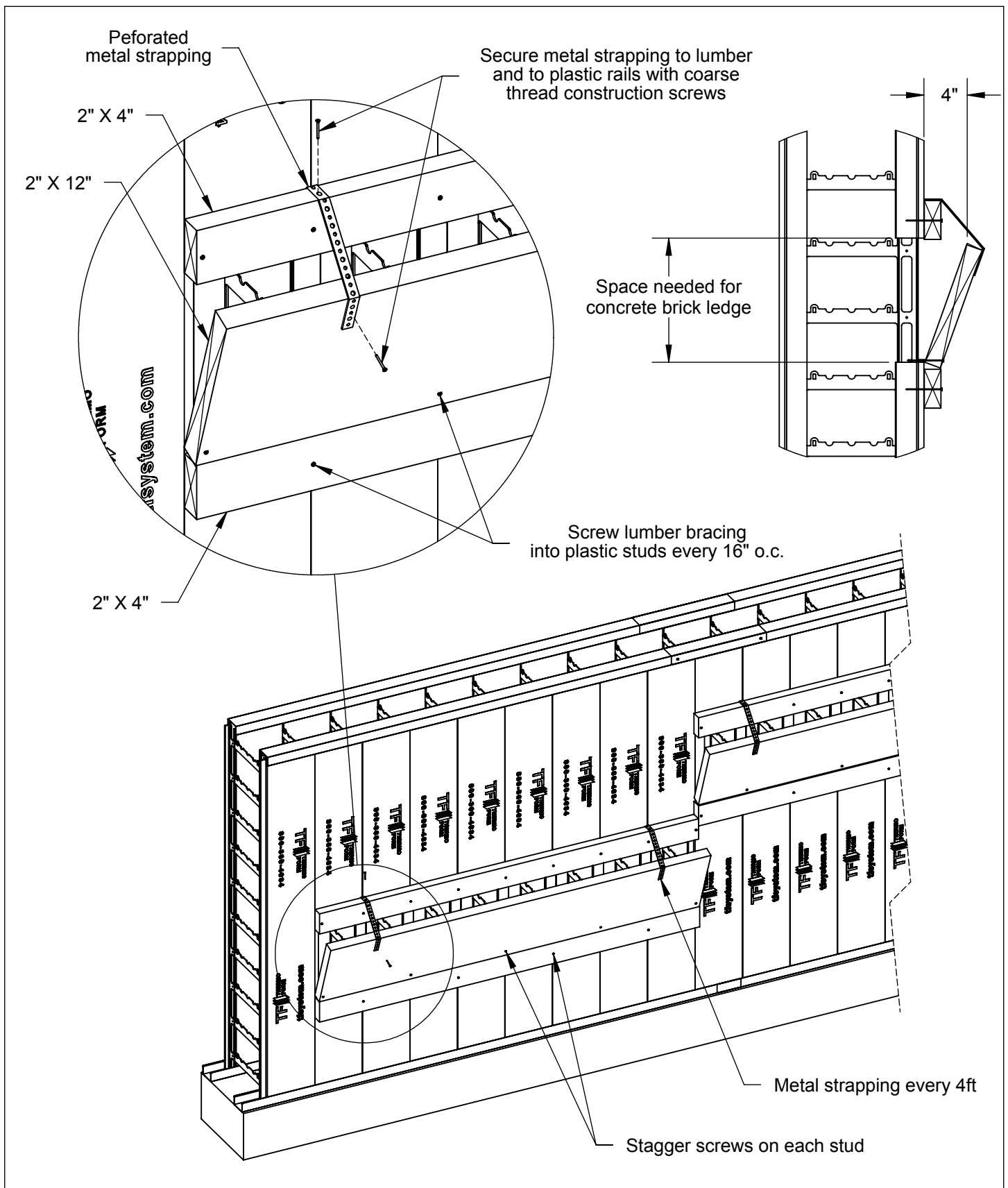

Corner With Brick Ledge- Without Bracing

note: width of corner brick ledge panel is the same as standard width shown on page 4.

The wall shown is a 10" wall

notch out for 2x6

12-5/8"

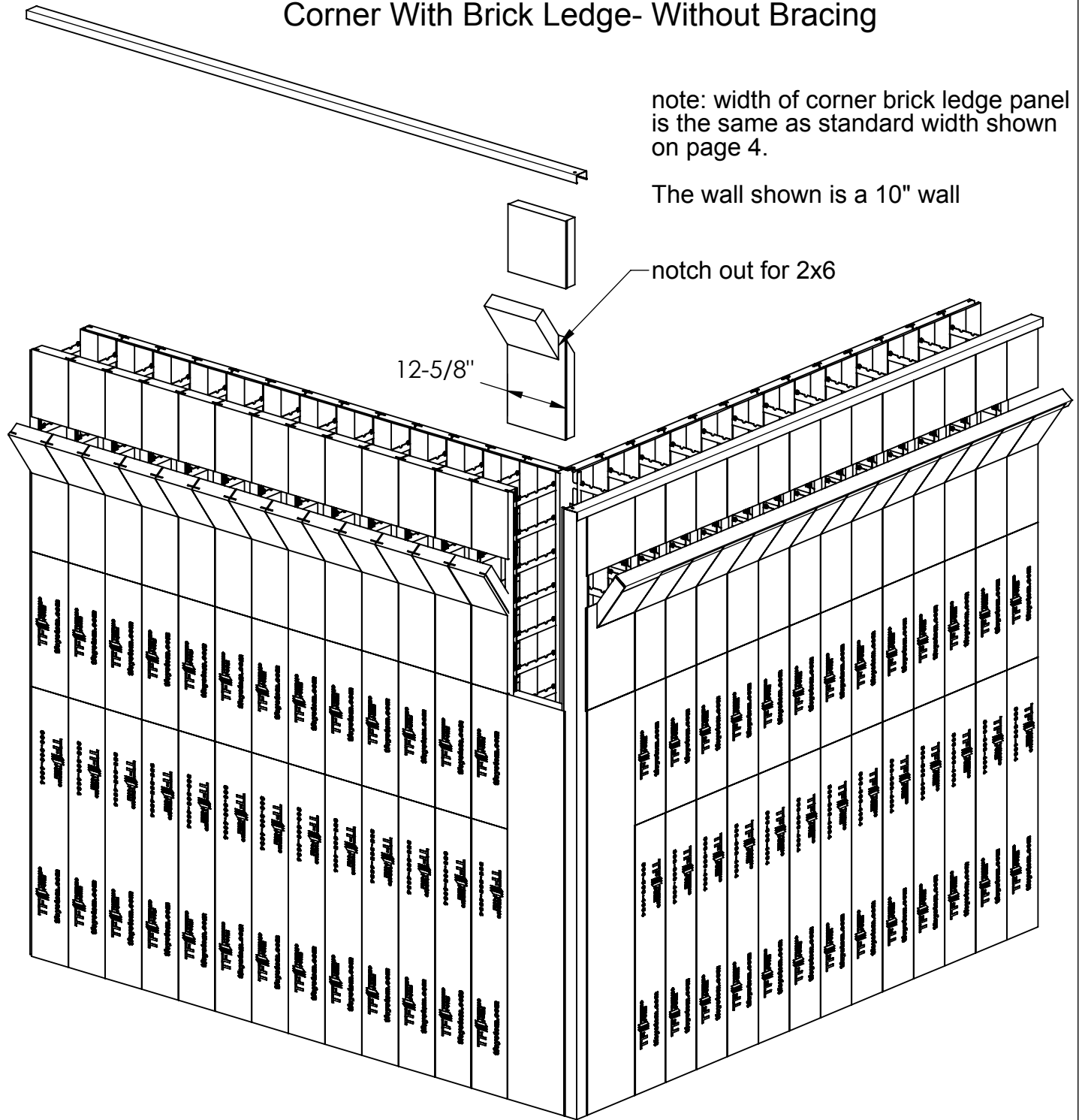

Corner With Brick Ledge- Without Bracing

TF Forming Systems, Inc.
800-360-4634
www.TFSystem.com

ThermoForm

Date: 7/21/2016



Bracing a Corner With a Brick Ledge

Brace the same as a normal 90 deg corner with the exception of a horizontal waler directly under the tapered panels and a ledger board across the entire top of the ledge.

Look at corner bracing for exact dimensional placement of braces.

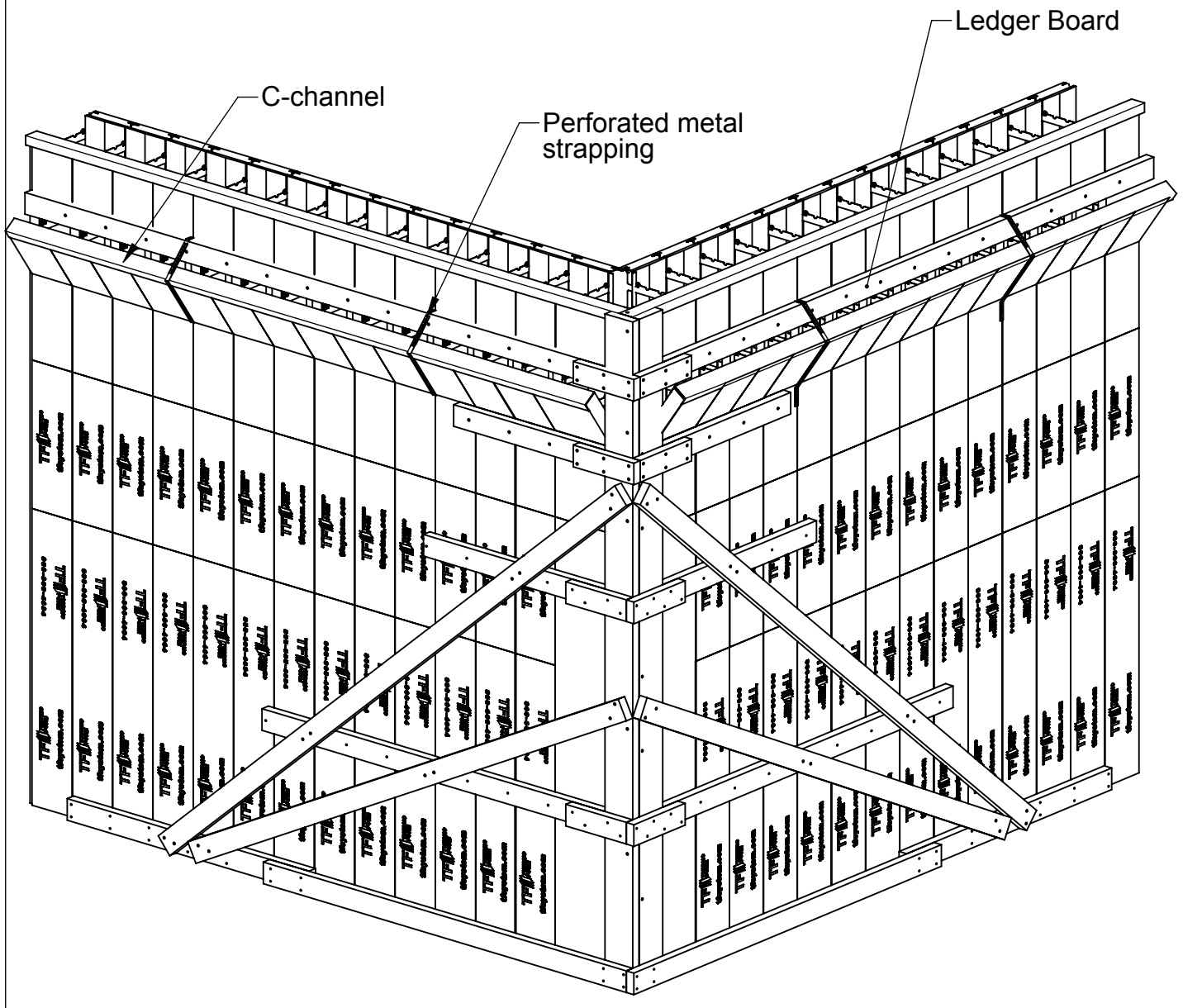

Final Brick Ledge Corner- Placing the Steel Cross-Over Piece

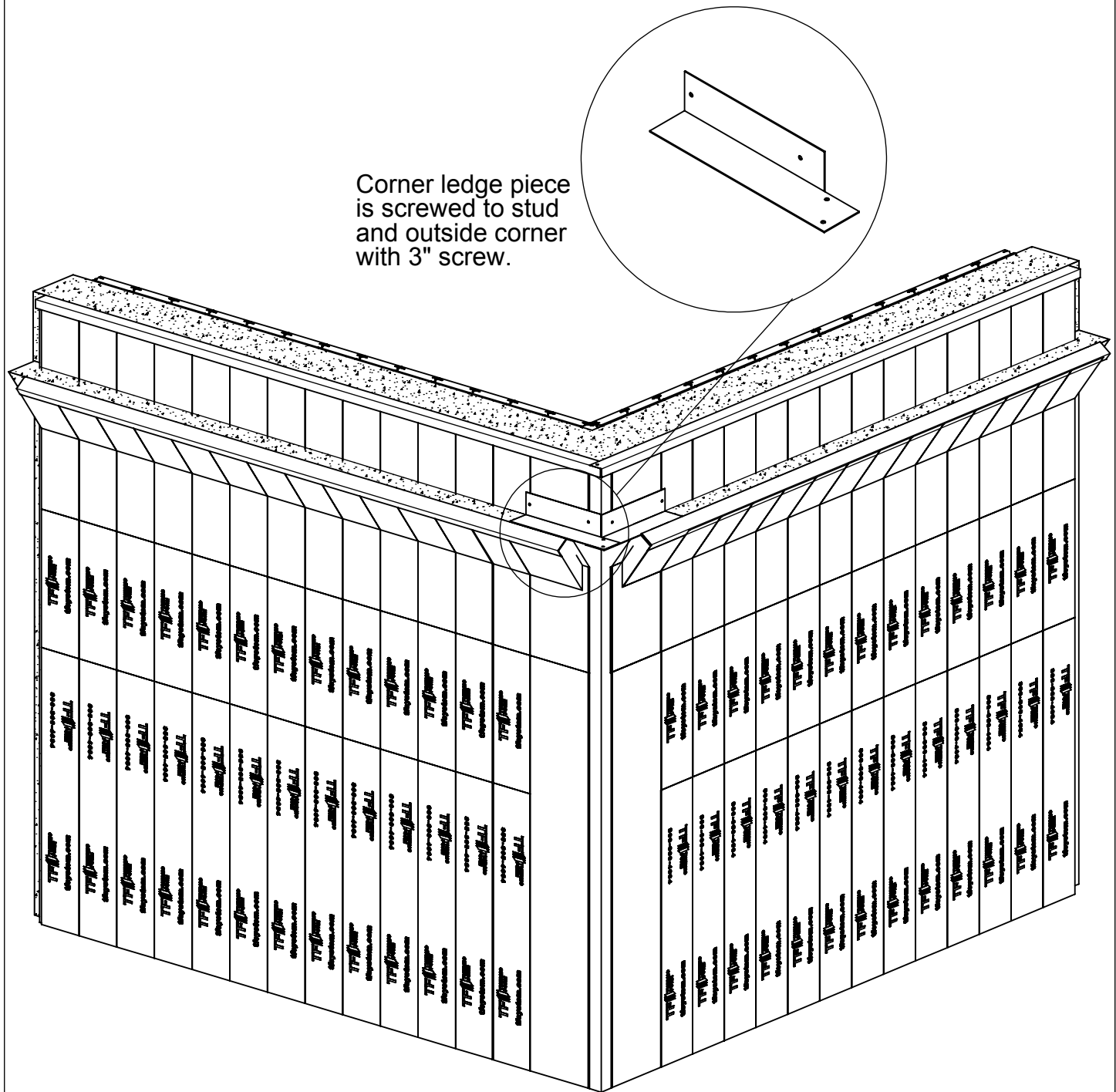

Final: Corner With Brick Ledge

TF Forming Systems, Inc.
800-360-4634
www.TFSystem.com

ThermoForm

Date: 7/21/2016

Proper Offset Wall Bracing

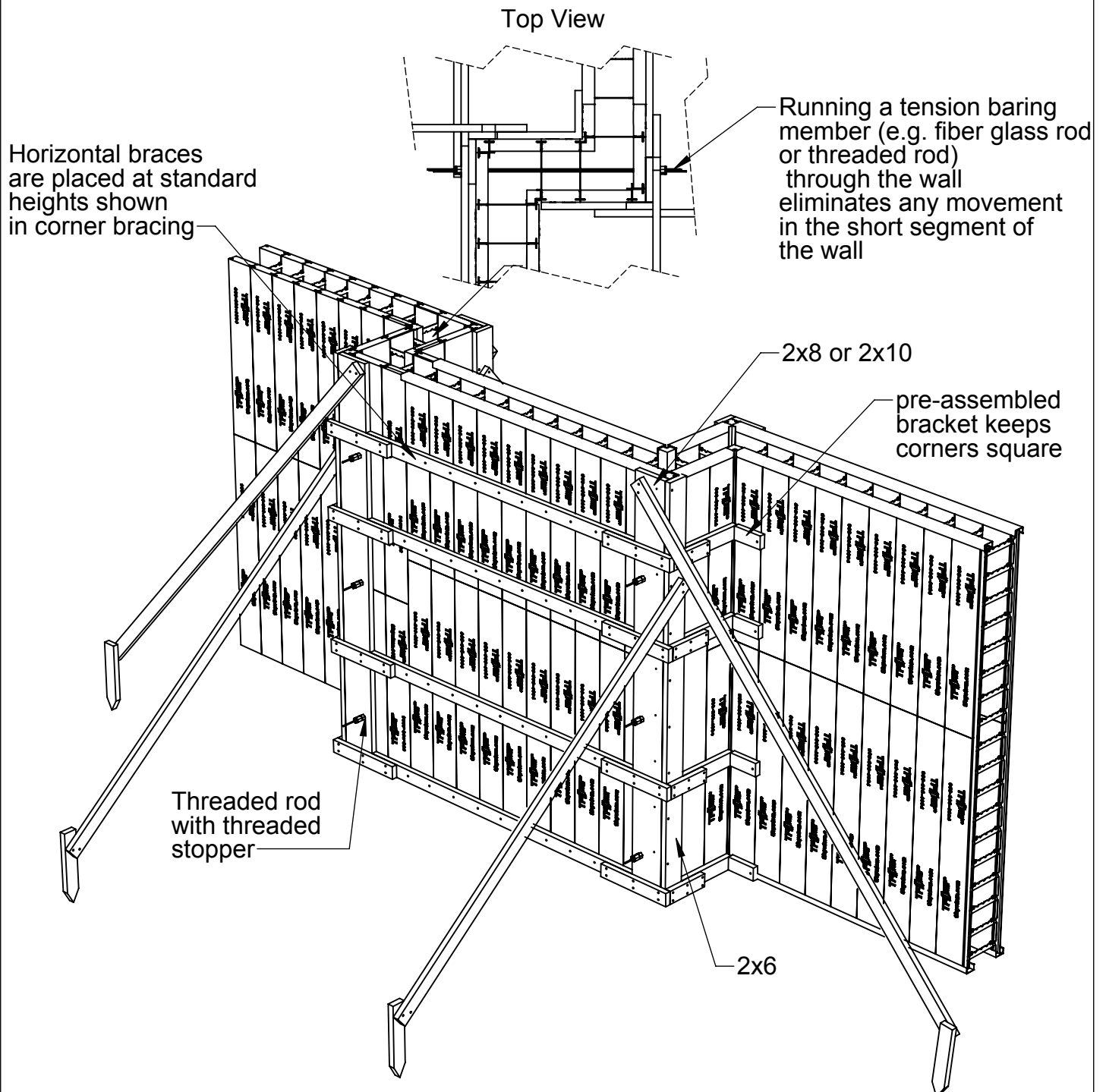

Bracing an Offset Wall (Exterior View)

TF Forming Systems, Inc.
800-360-4634
www.TFSystem.com

ThermoForm

Date: 7/19/2016

Proper Offset Wall Bracing

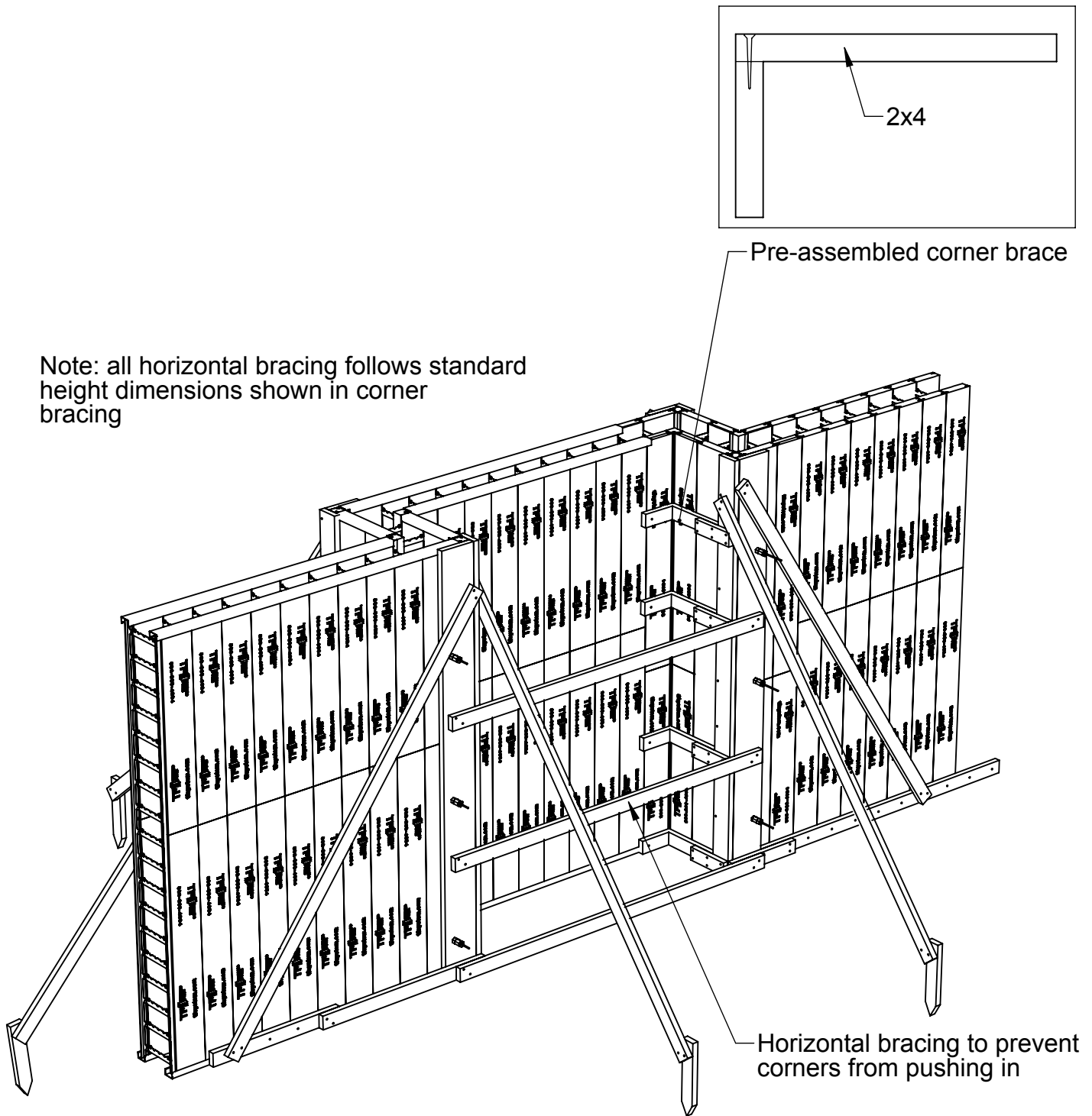

Building Steps

1. Mark a line to represent the outside radius of the poly panels
2. Nail down wooden blocks and strap along the marked line (allow enough room for strap thickness)
3. Screw bottom strap to wooden blocks
4. Erect outside poly panels and plastic studs
(cut a bevel on each side of outside panels for tight radius wall situations, see next page)
5. Screw through bottom strap, through poly, and into plastic studs to hold bottom in place
6. Install inside poly panels after exterior panels are in place
7. Inside poly panels will need to be ripped narrower and grooved
8. Attach kickers/bracing as you build

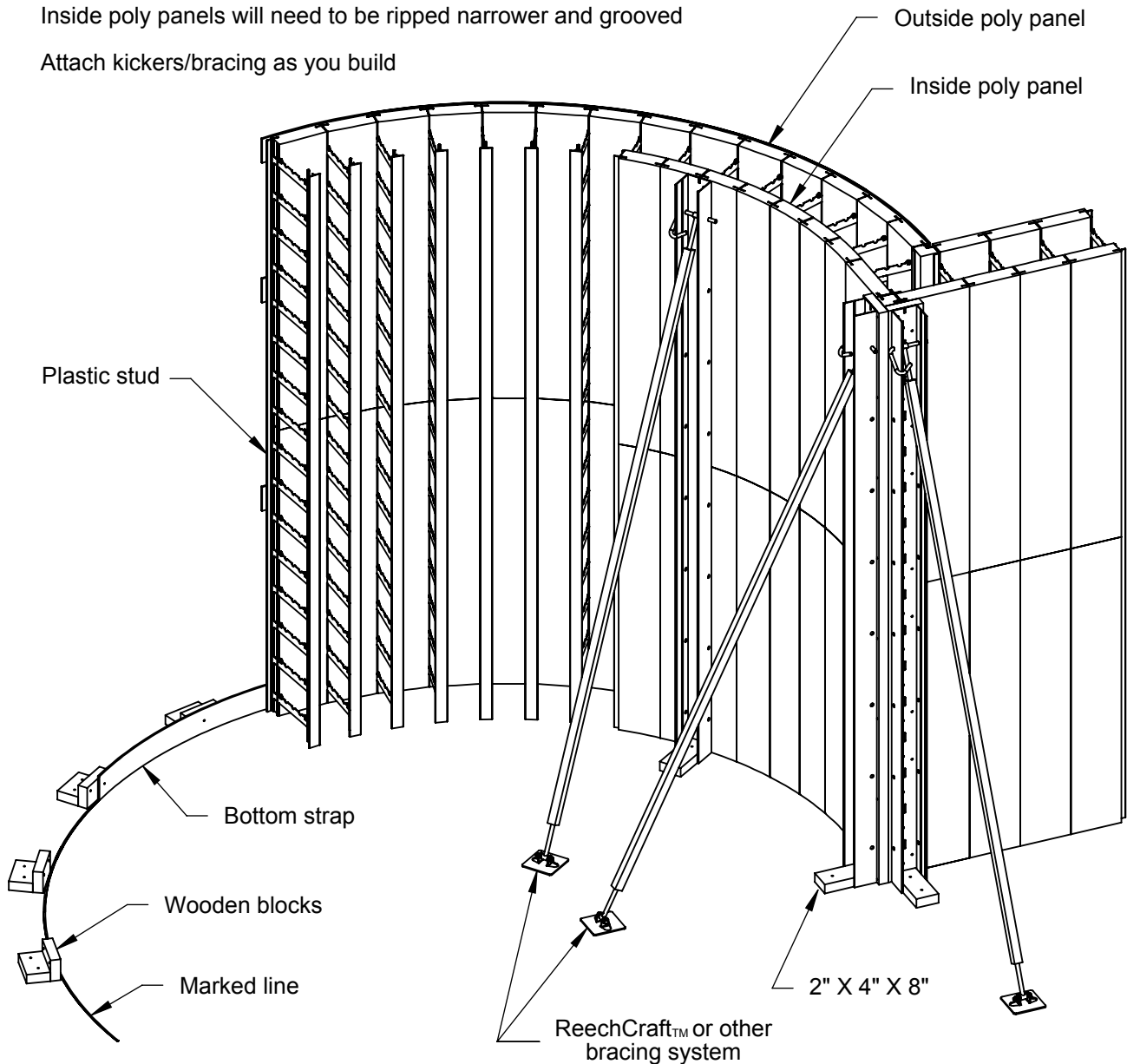



Outside radius poly panels can be beveled to achieve a tighter radius

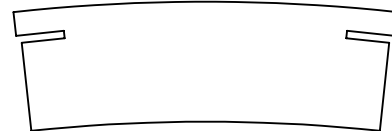

Curved panels can be custom made for walls with tight radius (Contact TF System for details)

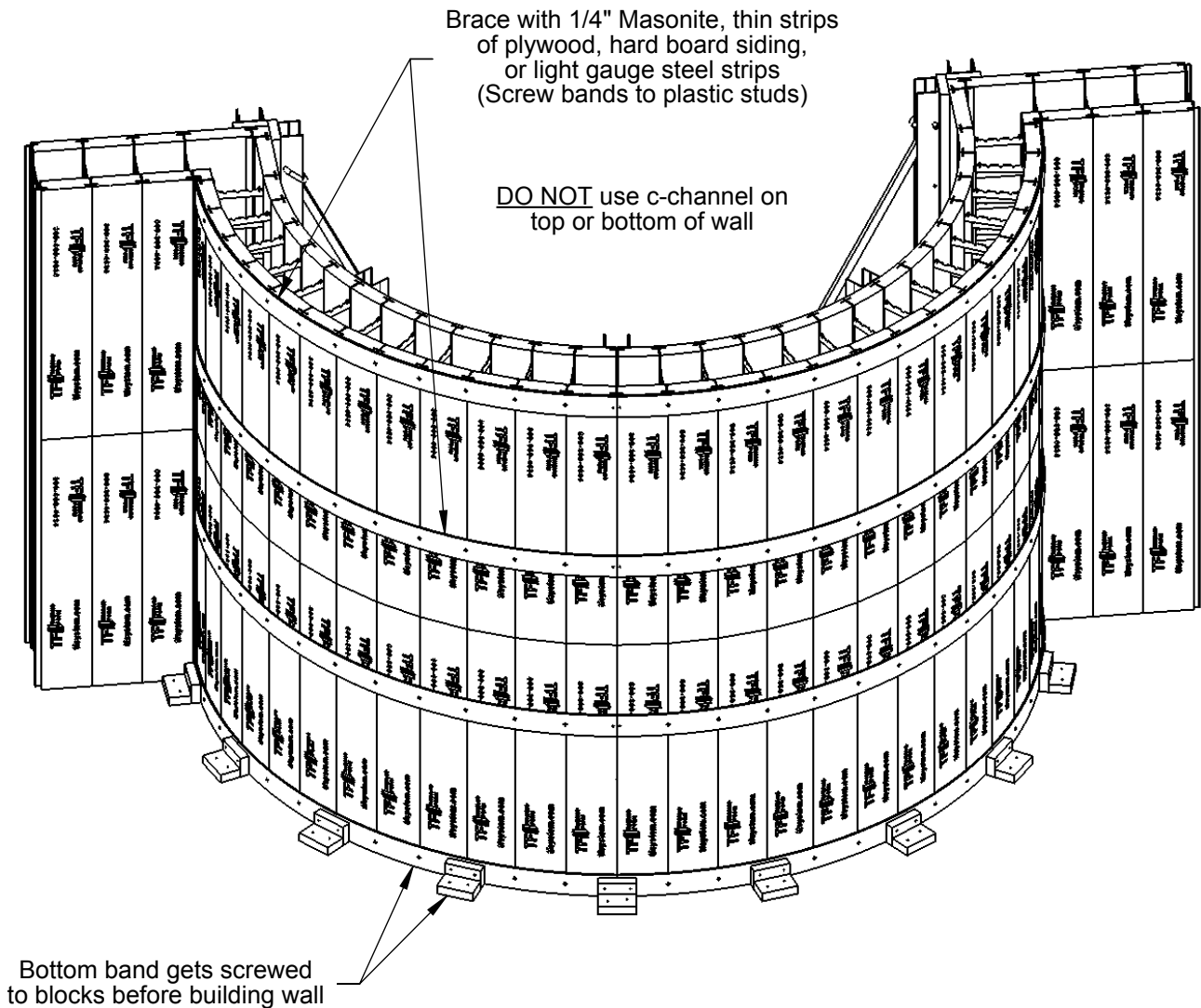

Window bucks should be assembled ahead of time for increased speed and efficiency at the job site

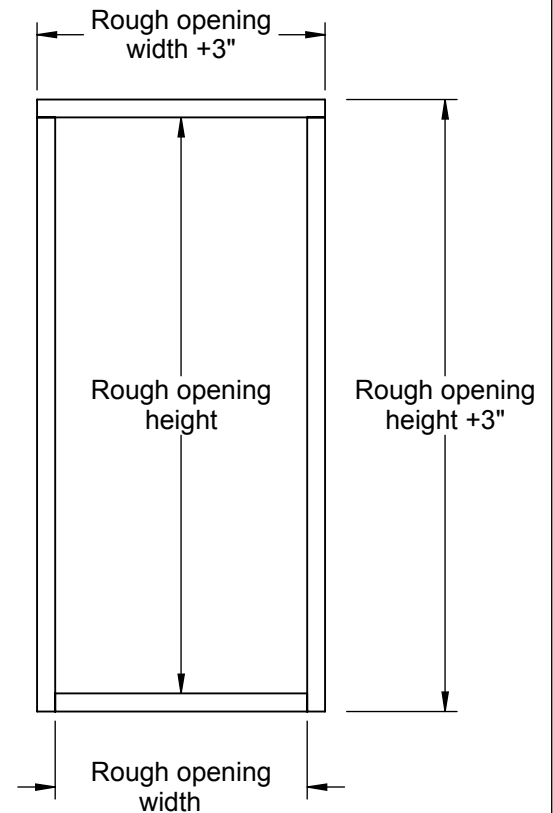
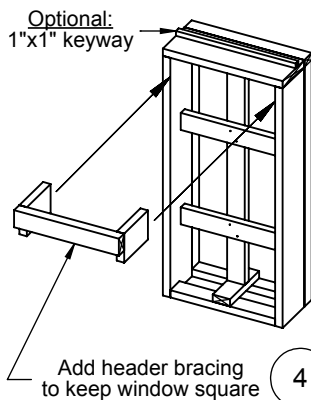
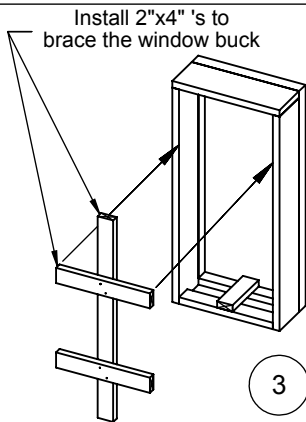
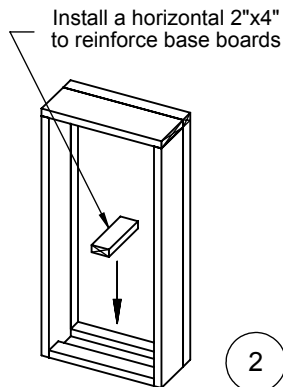
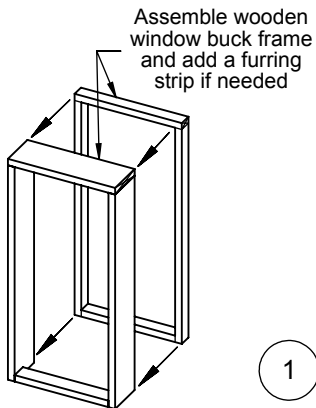
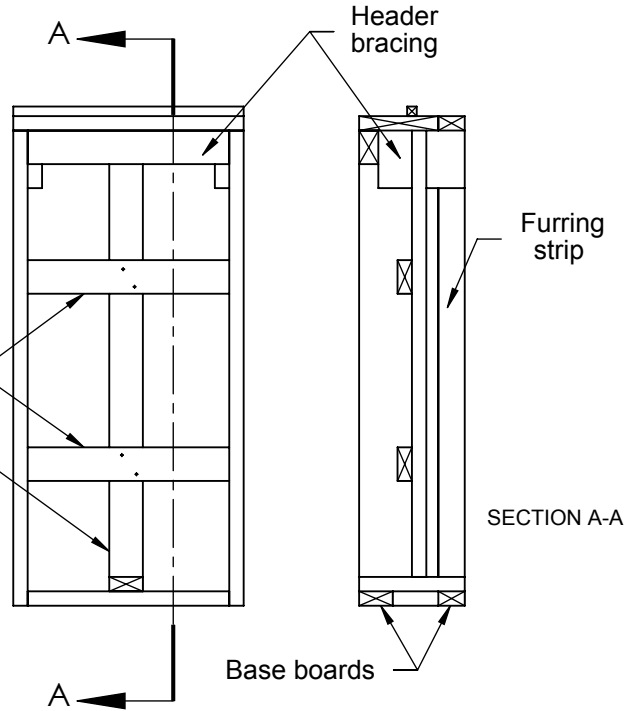
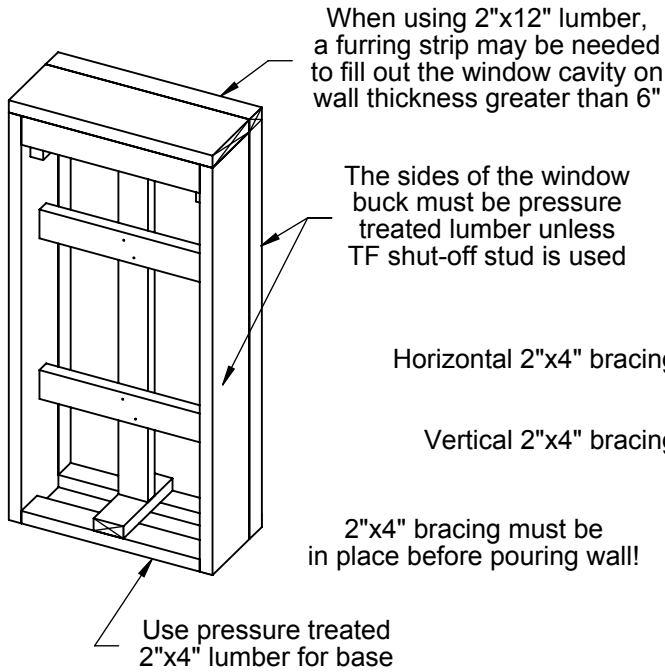

**Staple down felt-paper
to cover entire top surface
of wood buck frame**

**Install c-channel to top of
window buck with screws**

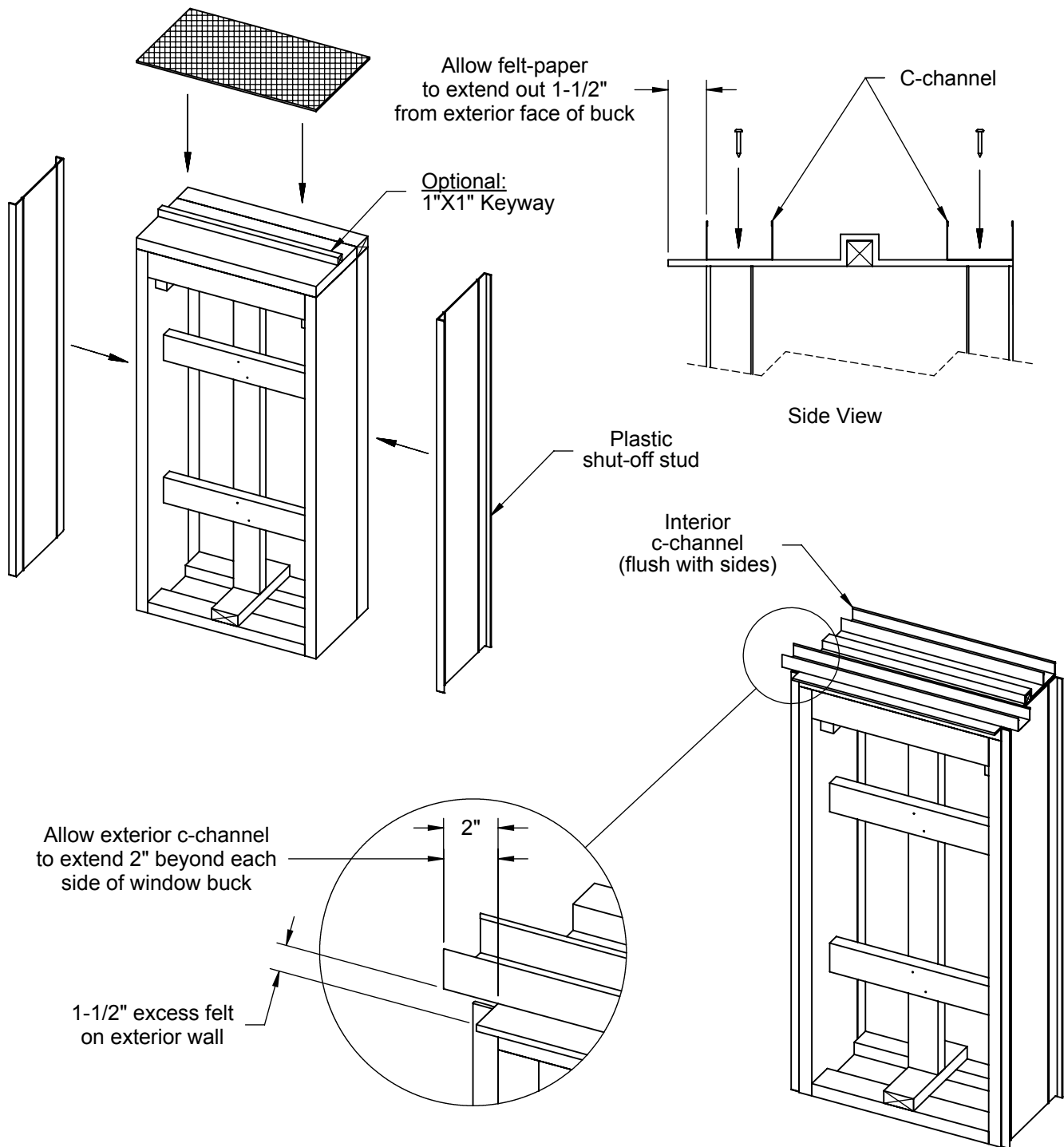

Cut poly splice pieces to desired width to achieve accurate length for window buck installation

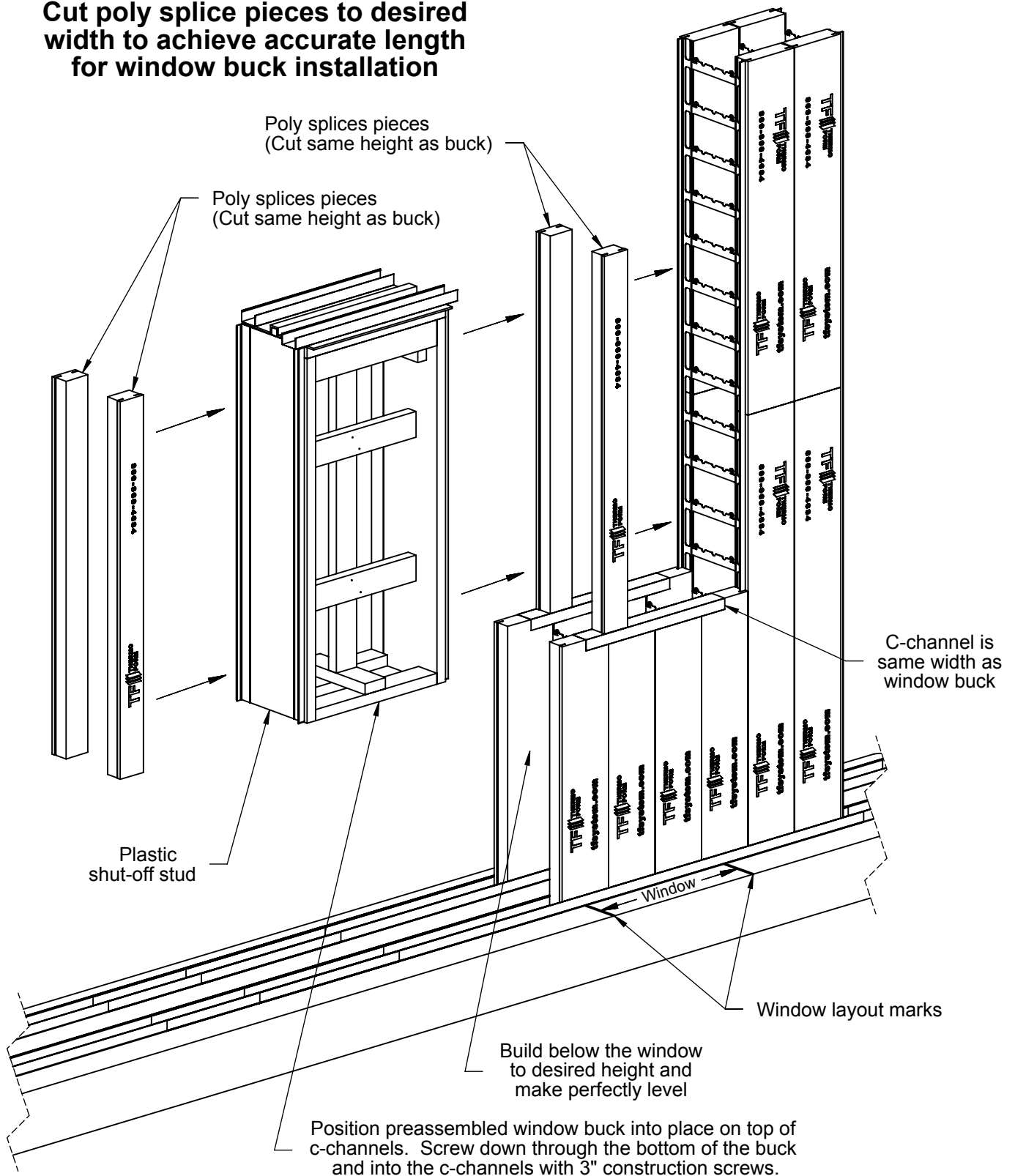

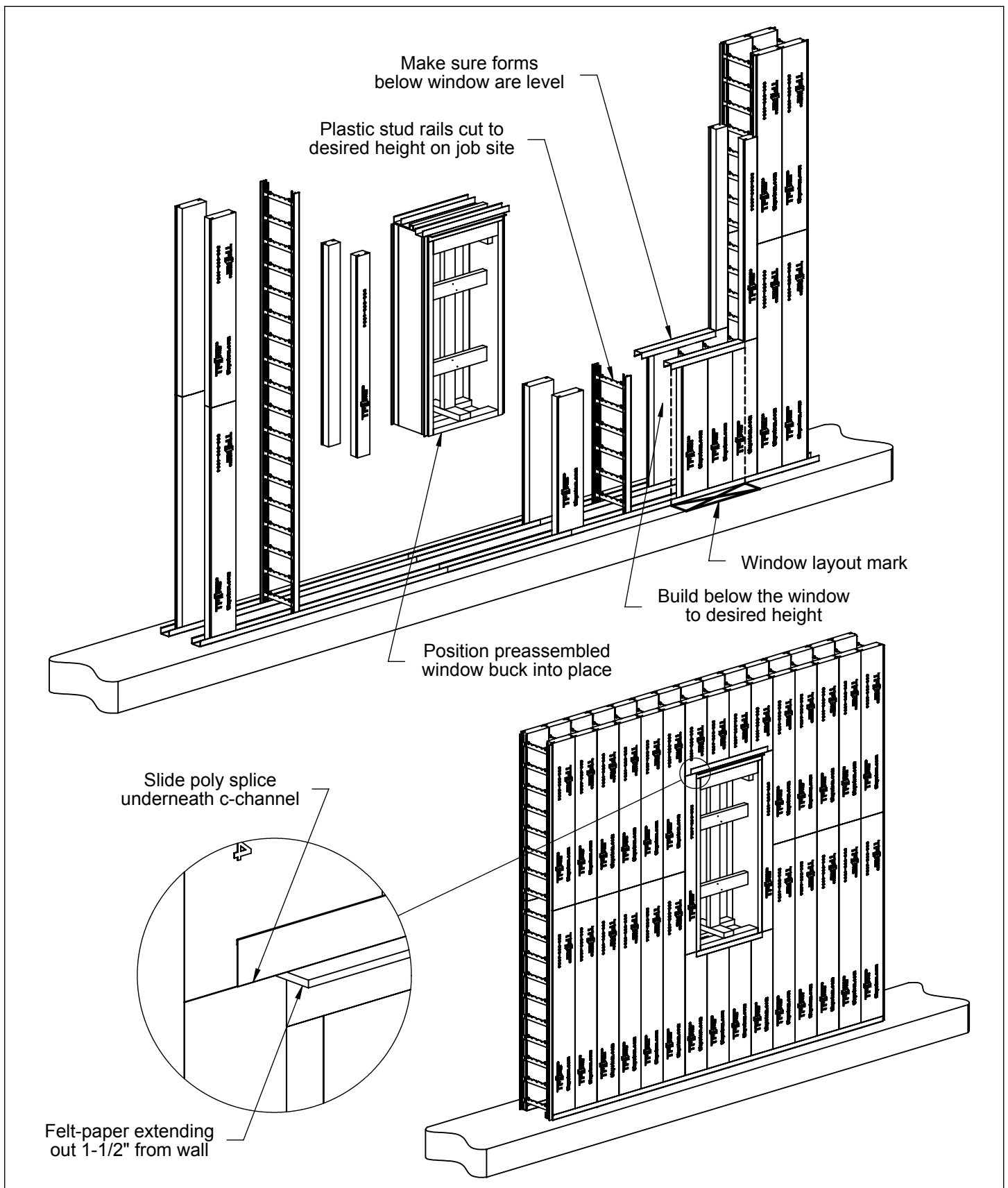

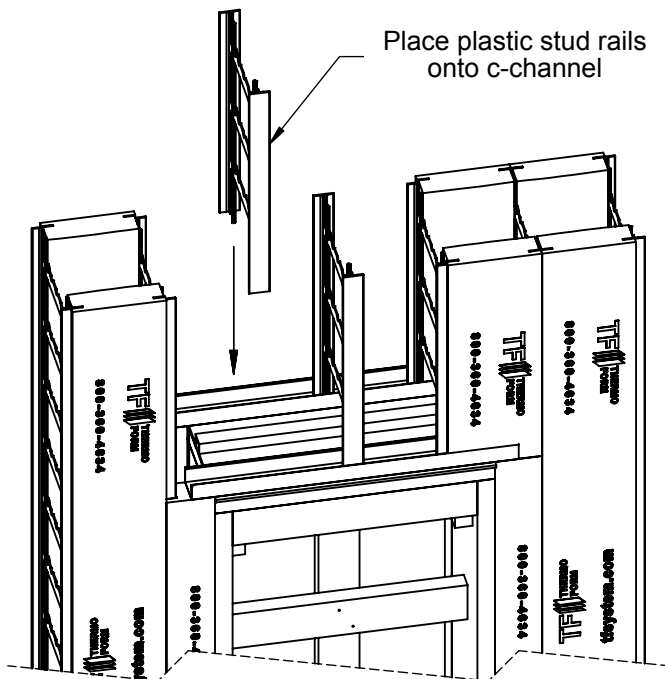

Place plastic stud rails
onto c-channel

Remember to install header
reinforcement according to code

Adjust the cut of the plastic
studs so there are at least two
cross-ties per stud.

Cut so that cross-ties line up
horizontally with the cross-ties
on the full rails on either side
of opening.

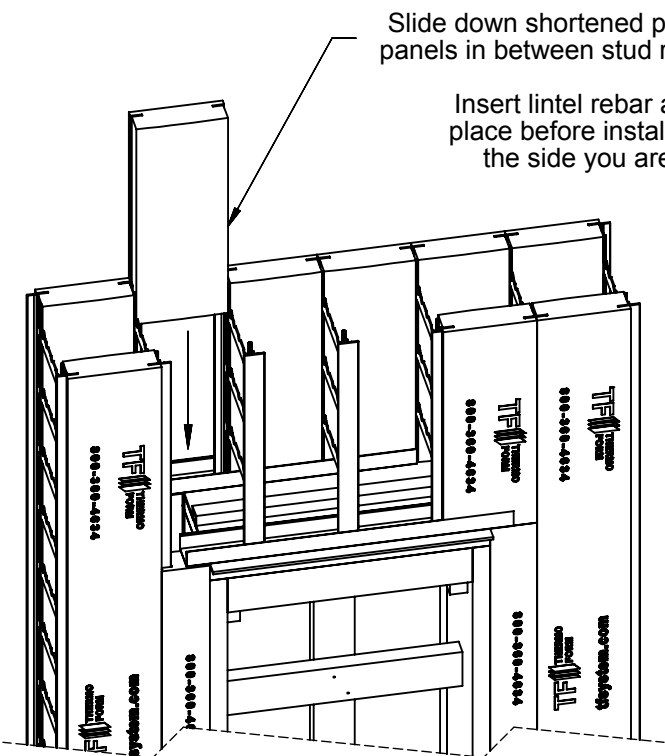
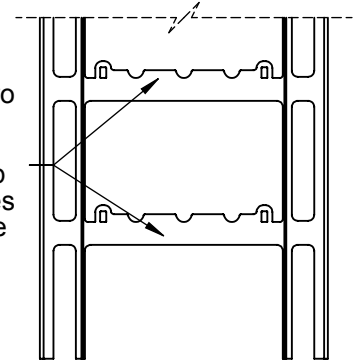

Slide down shortened poly
panels in between stud rails

Insert lintel rebar and collar tie into
place before installing the panels on
the side you are working from

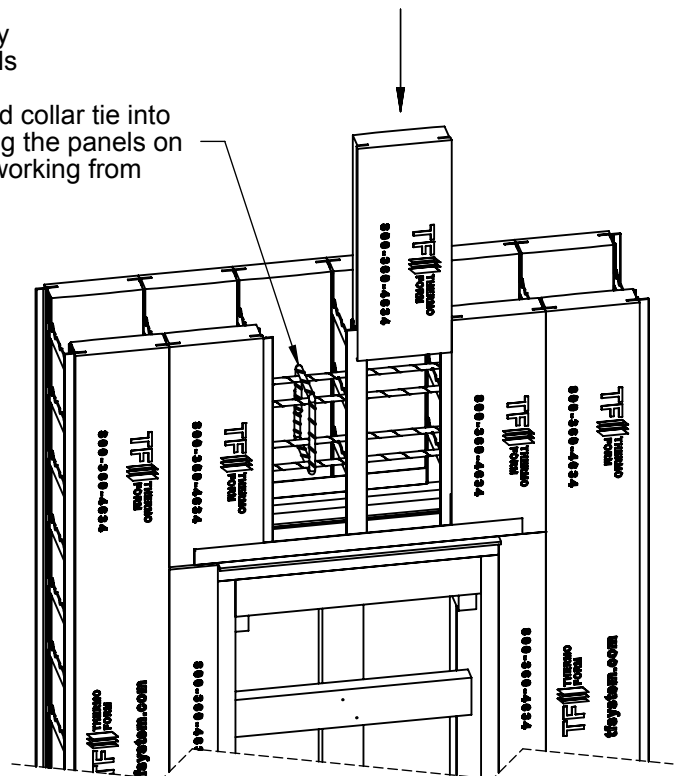

Door bucks should be assembled ahead of time for increased speed and efficiency at the job site

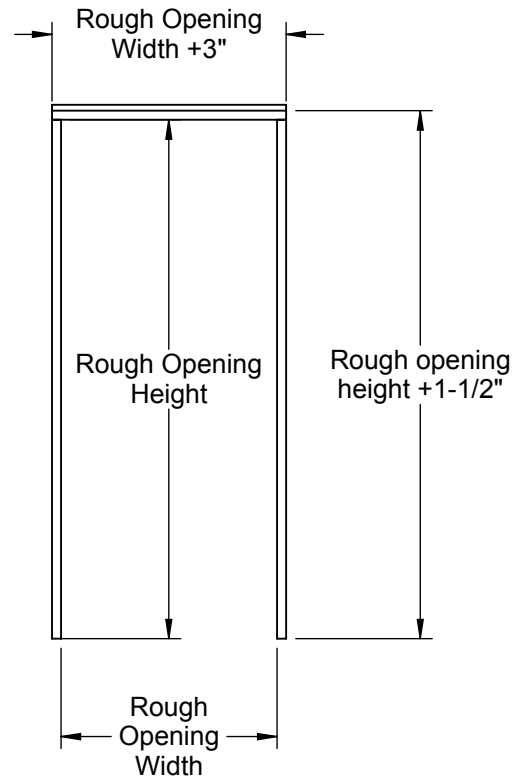
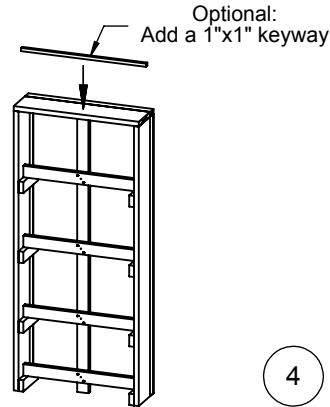
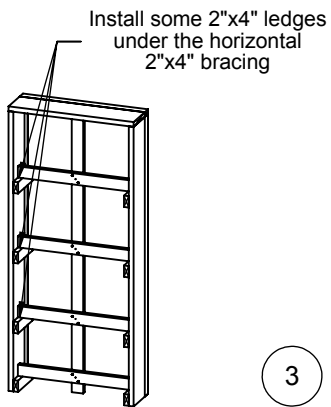
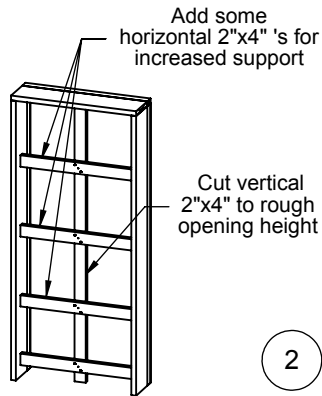
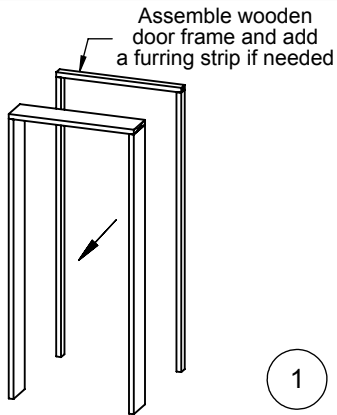
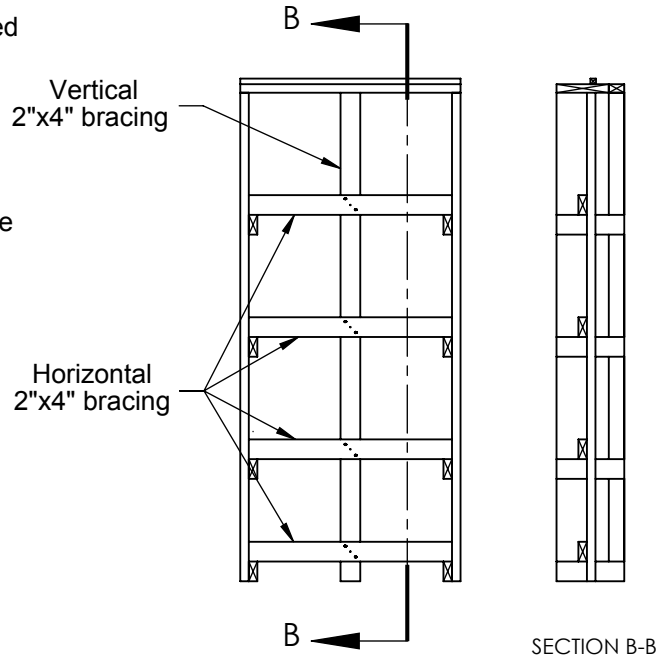
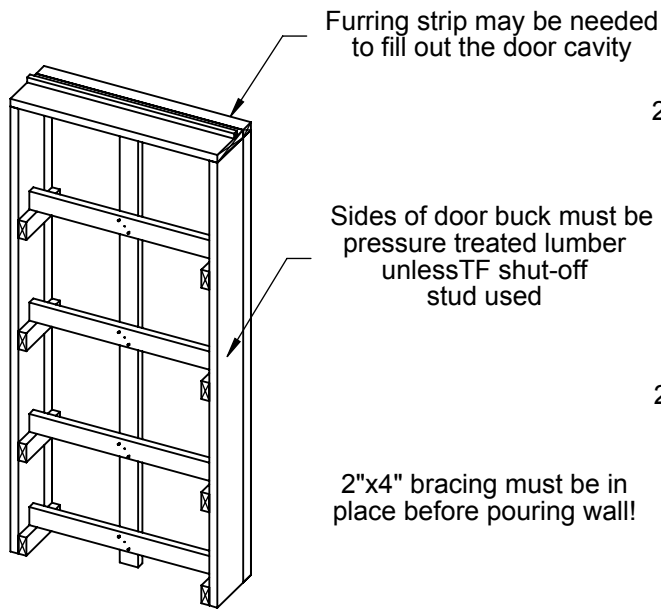

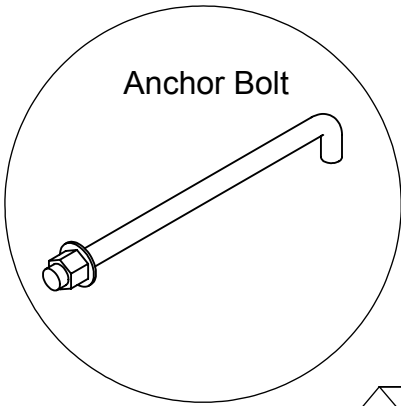

Embed anchor bolts, according to code requirements, on both sides of door buck

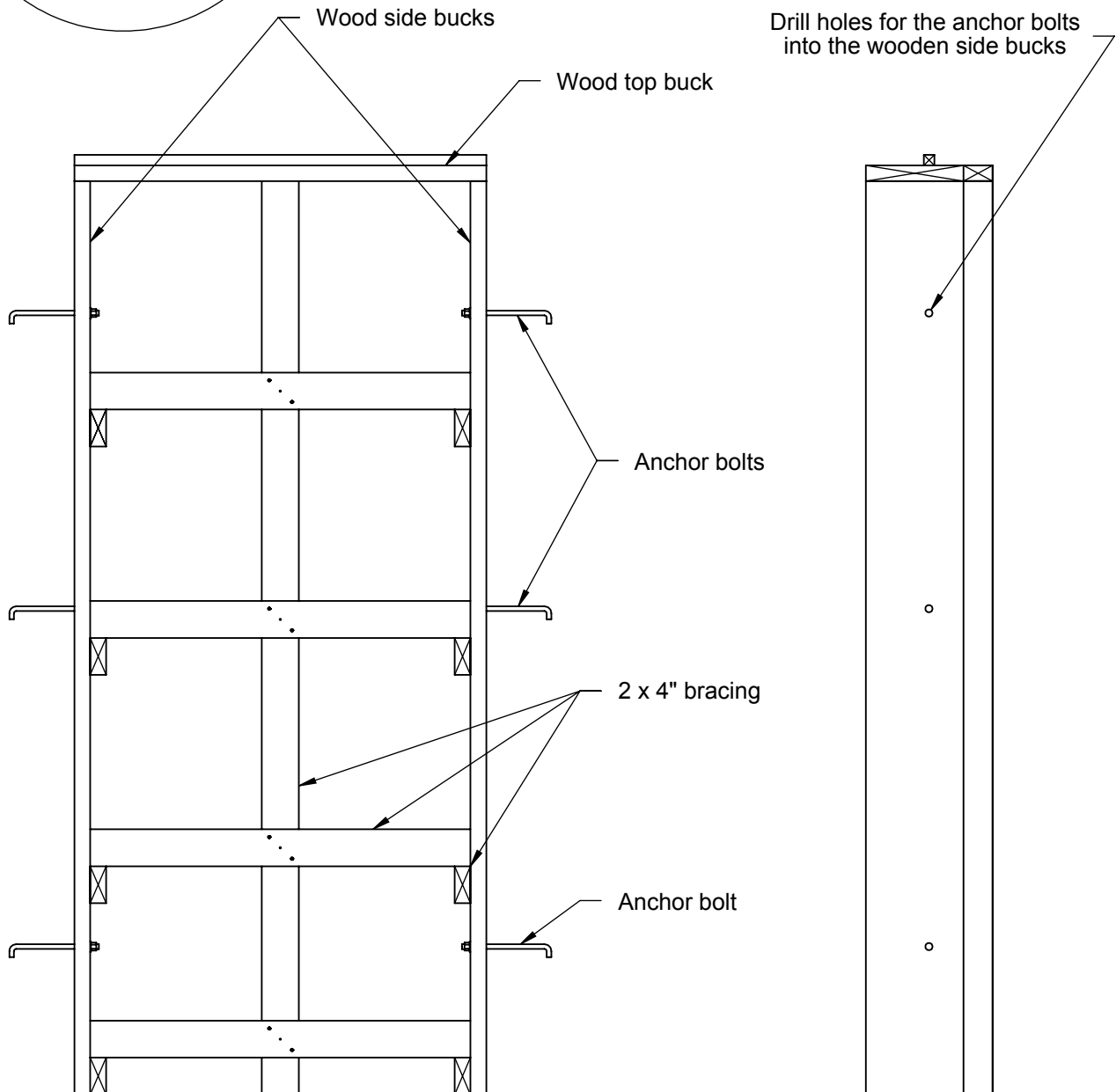

Staple down felt-paper to cover entire top surface of wood buck frame

Install c-channel to top of door buck with screws

Staple felt paper to cover entire top of wooden buck

1-1/2" wider than wood buck, let excess material extend to the exterior

C-channel

1-1/2"

Exterior

Side View

Plastic shut-off stud

Interior c-channel

Exterior c-channel

Cut exterior c-channel to extend 2" beyond each side of door buck

1-1/2" excess felt on exterior wall

2"



Installing Felt & C-Channel

ThermoForm

TF Forming Systems, Inc.
800-360-4634
www.TFSystem.com

Date: 9/11/2013

