

90° Corner Assembly

TF Forming Systems, Inc  
800-360-4634  
[www.TFSystem.com](http://www.TFSystem.com)

ThermoForm

Date: 9/10/2013

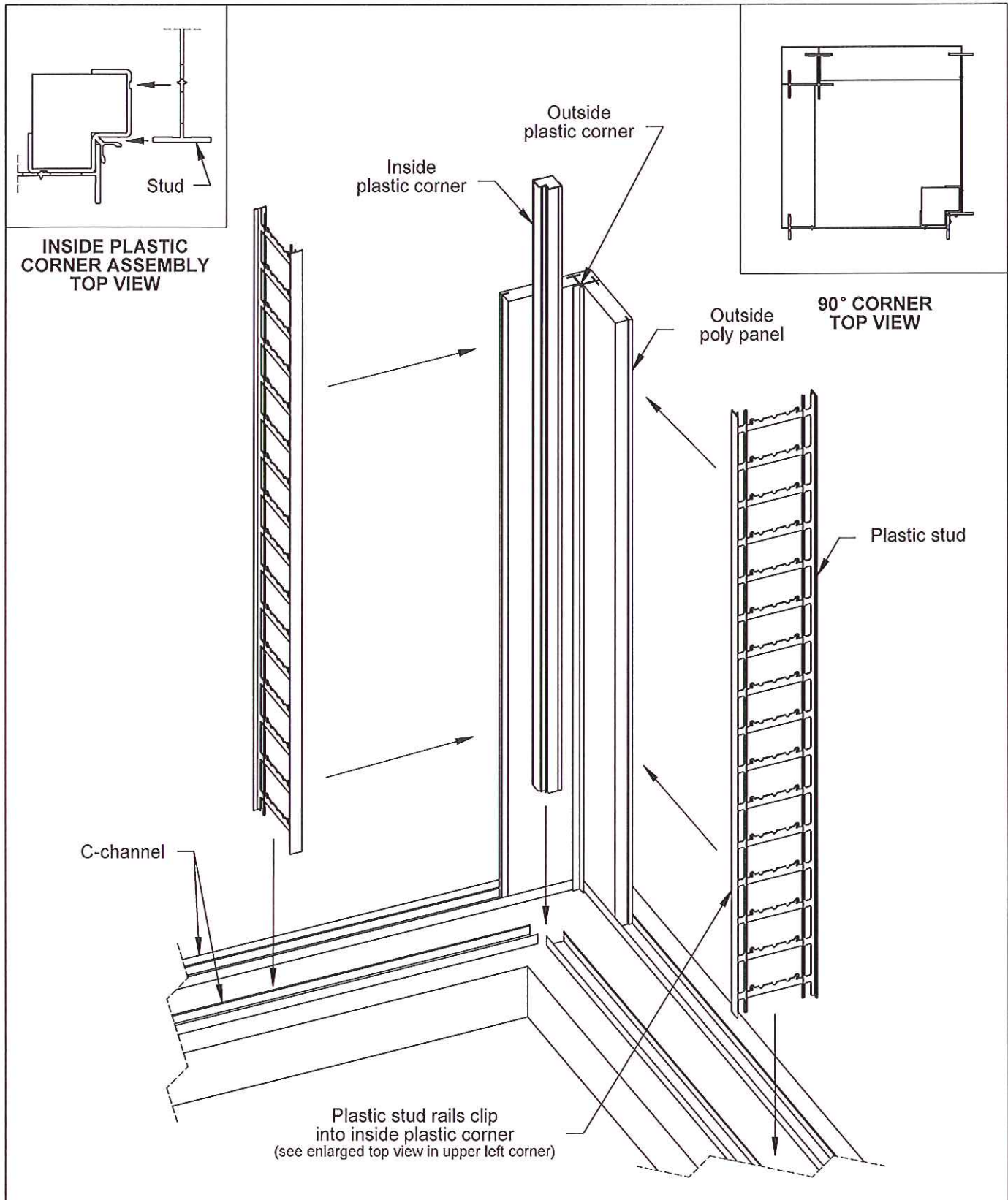

90° Corner Assembly

TF Forming Systems, Inc  
 800-360-4634  
[www.TFSystem.com](http://www.TFSystem.com)

ThermoForm

Date: 9/11/2013

**C-CHANNEL SHOULD BE SECURED TO BOTH THE PLASTIC STUD AND OUTSIDE PLASTIC CORNER**

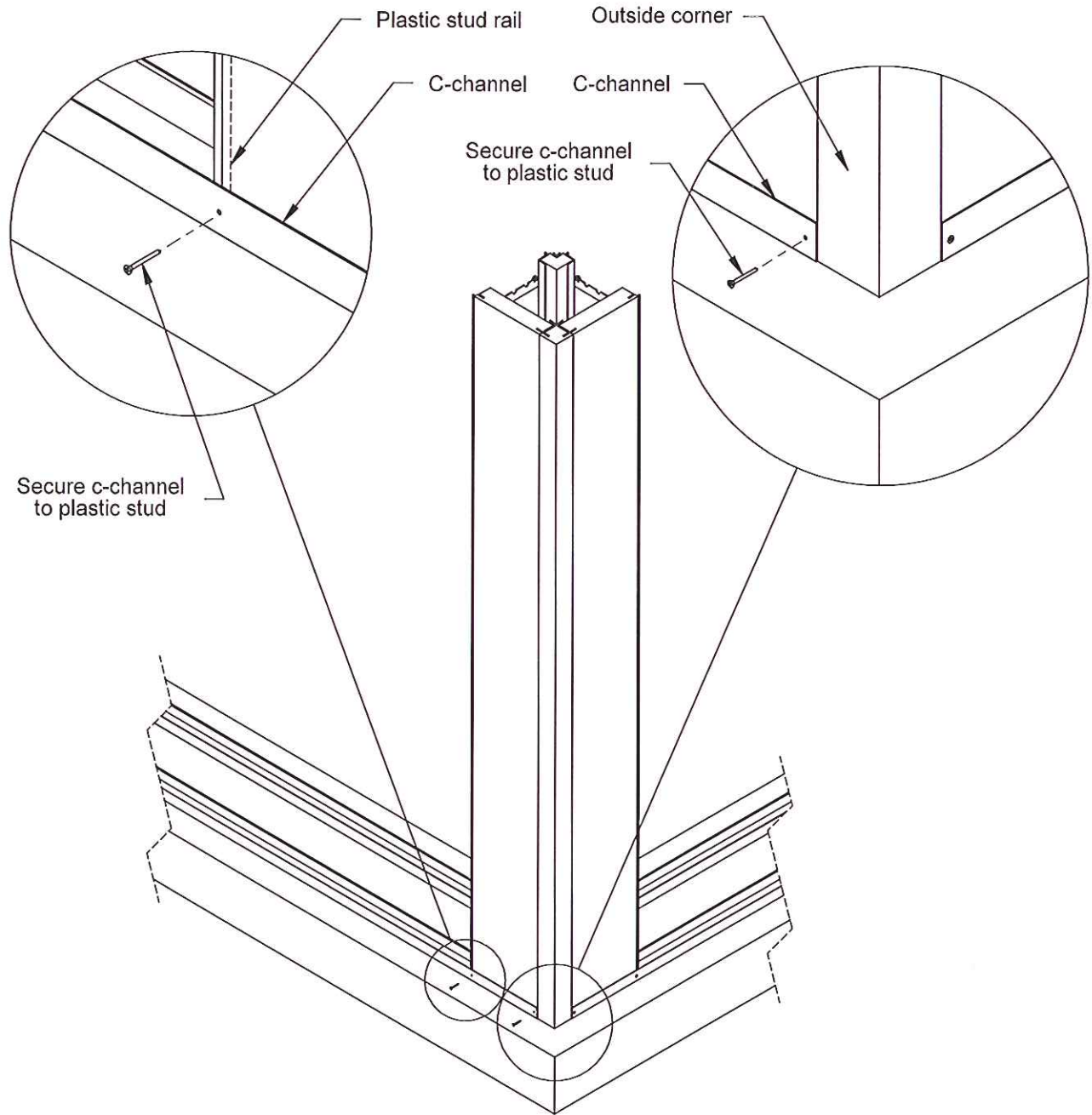

90° Corner Assembly

TF Forming Systems, Inc  
800-360-4634  
[www.TFSystem.com](http://www.TFSystem.com)

ThermoForm

Date: 9/10/2013

Always follow applicable codes for rebar configuration and spacing

Install corner rebar as the corner is being assembled

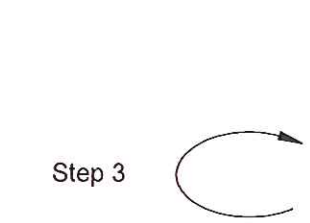
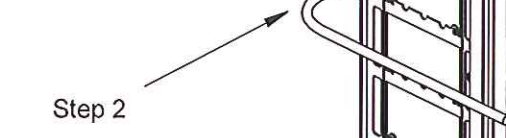
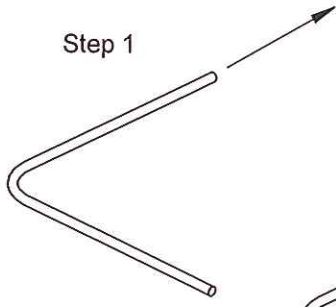

Thread rebar into corner assembly in a rotating motion

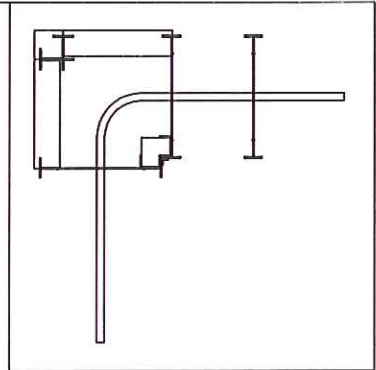
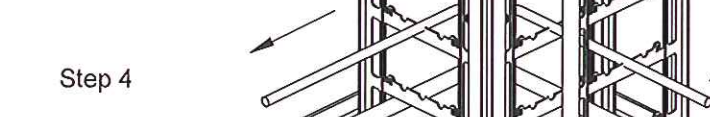

90° CORNER  
TOP VIEW

On longer corner rebar legs use another rail to support the end while building the walls



90° Corner Assembly

ThermoForm

TF Forming Systems, Inc  
800-360-4634  
www.TFSystem.com

Date: 9/10/2013